



REDWOOD COMPLEX

At the heart of El Rancho you will find our most popular venue for school camps or large groups.

The Redwood complex has 154 bunk beds in 18 classic bunk rooms, and is divided into 3 bunk room blocks, Poplar Lodge and Oregon Lodge with adjoining showers and toilets, and Willow Lodge, which has ensuite bathrooms.





ACCOMMODATION

POPLAR

Poplar Lodge consists of 6 bunk rooms that can sleep 11 people per room therefore offering a maximum occupancy of 66 beds.

The showers and toilets are located within the building just alongside the bunk rooms.



POPLAR LODGE

Sleeps 66 People

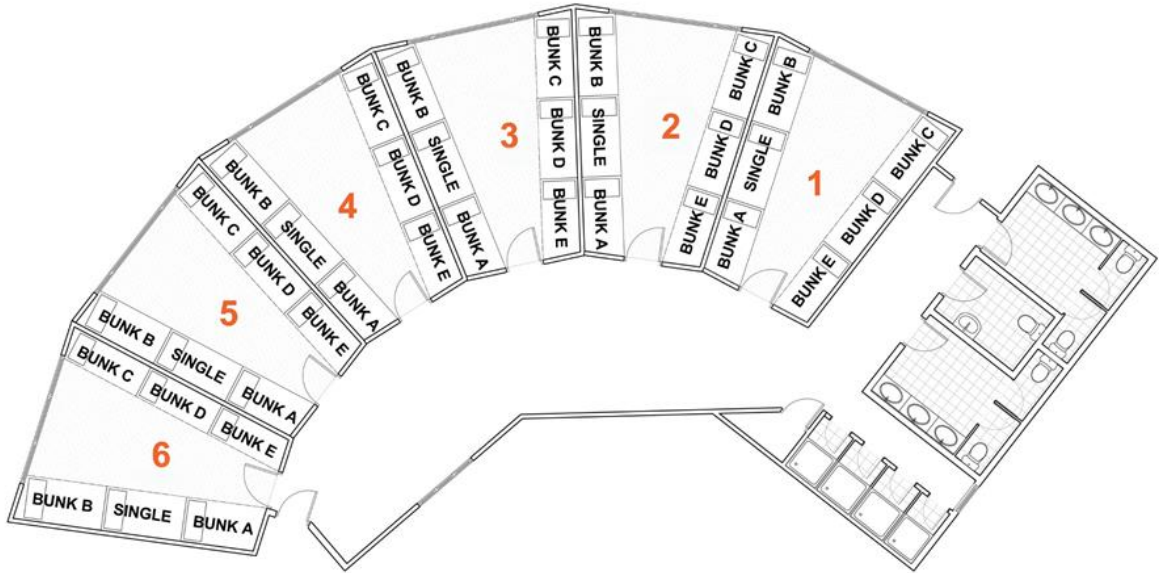

OREGON

Oregon Lodge consists of a ground floor and top floor unit that can sleep 28 people per floor therefore offering a maximum occupancy of 56 beds.

The showers and toilets are located in an amenities block a short walk from the bunk rooms.





OREGON LODGE

Ground Floor
Sleeps 28 People

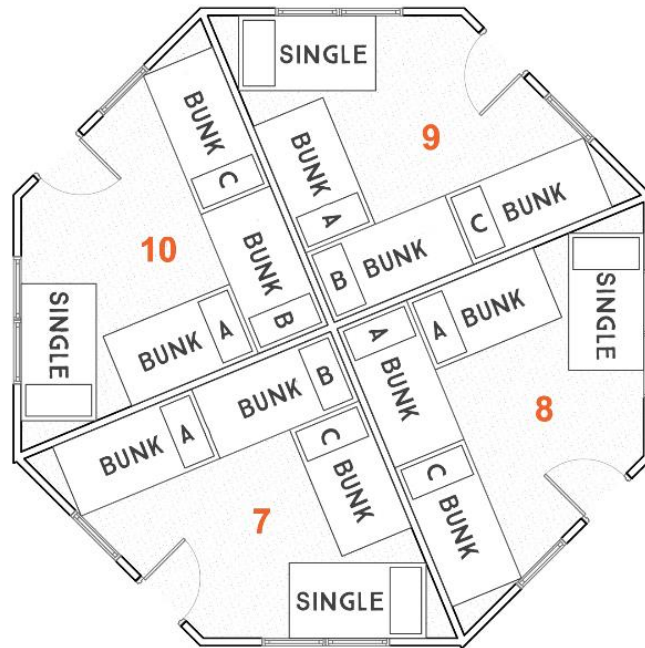



WILLOW

Willow consists of 4 bunk rooms that can sleep 8 people per room therefore offering a maximum occupancy of 32 beds with adjoining ensuite bathrooms. A layout of the unit is provided below.

All bunks come with just a mattress, please bring your own pillow and sleeping bag or bedding.

A bedding and linen set can be hired from the office if required.



WILLOW LODGE

Sleeps 32 People

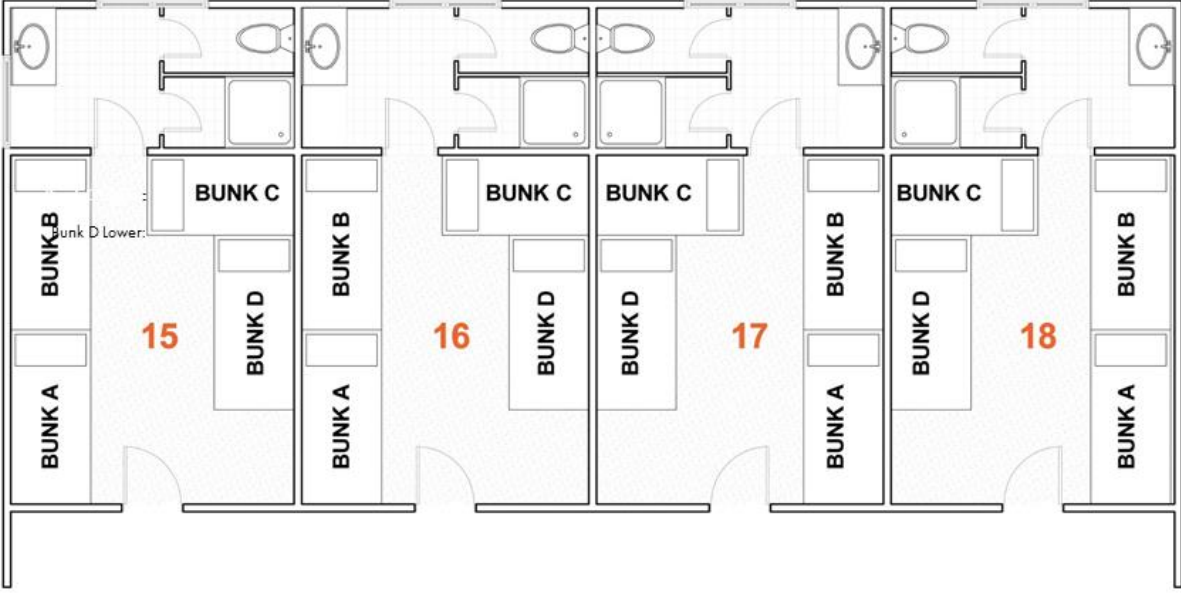



MEETING SPACES

At the centre is **Redwood Hall**, a large games hall with a huge log-burning fireplace and two heat pumps. The concrete floor can be carpeted for more comfortable conferences or large meetings.

Seating for approximately 250 people can be made available for this space.





Redwood Auditorium is a theatre-style meeting room with a small stage. There is upholstered seating available for 150 people. It's equipped with a data projector and piano. A sound system is available for hire.





There are also two **Small Meeting Rooms**.

One has couches and a TV on the wall; the other space has executive style seats around a boardroom table with a whiteboard on the wall, along with couches and comfortable chairs also.





DINING ROOM

Redwood Dining Room can cater for up to 280 people in one sitting. We can also convert Redwood Hall into a dining room for extra seating or to create a separate function room.





There is also a large deck through the door from the Dining Room. This has built in seating and is in a stunning setting amidst the trees, looking towards the pond.

